

Standing Cube

1. Use two sheets of the same size paper. Fold each like a *hamburger*. However, fold one side one half inch shorter than the other side. This will make a tab that extends out one half inch on one side.
2. Fold the long side over the short side of both sheets of paper, making tabs.
3. On one of the folded papers, place a small amount of glue along the the small folded tab, next to the *valley* but not in it.
4. Place the non-folded edge of the second sheet of paper square into the *valley* and fold the glue-covered tab over this sheet of paper. Press flat until the glue holds. Repeat with the other side.
5. Allow the glue to dry completely before continuing. After the glue has dried, the cube can be collapsed flat to allow students to work at their desks. The cube can also be folded into fourths for easier storage, or for moving it to a display area.

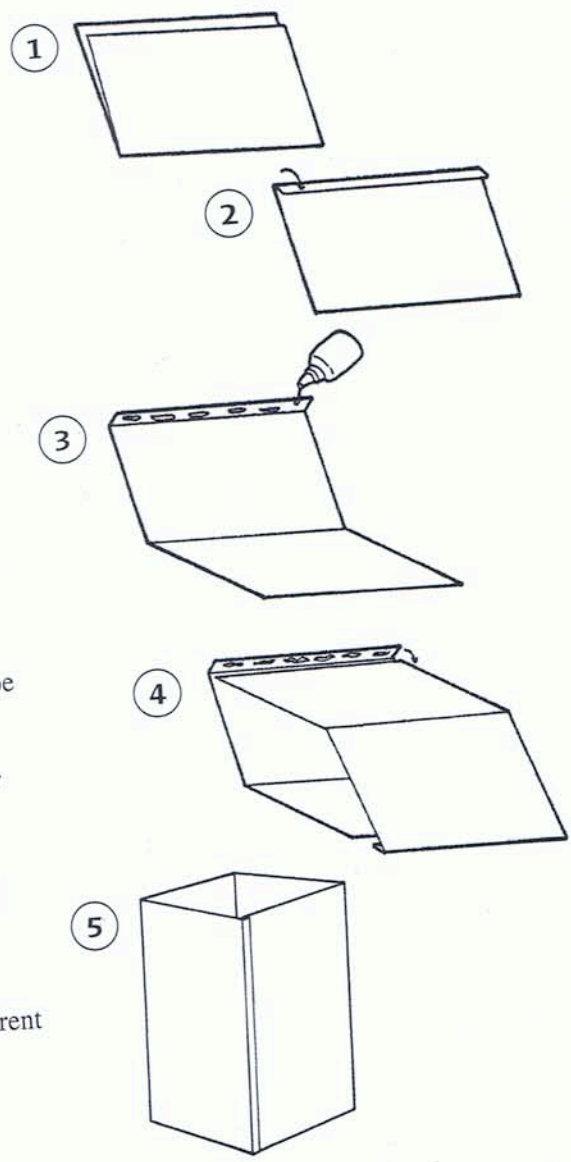

Use with data occurring in fours or make it into a project. Make a small display cube using 8 1/2" x 11" paper. Use 11" x 17" paper to make large project cubes that you can glue other books onto for display. Notebook paper, photocopied sheets, magazine pictures, and current events also can be displayed on the large cube.

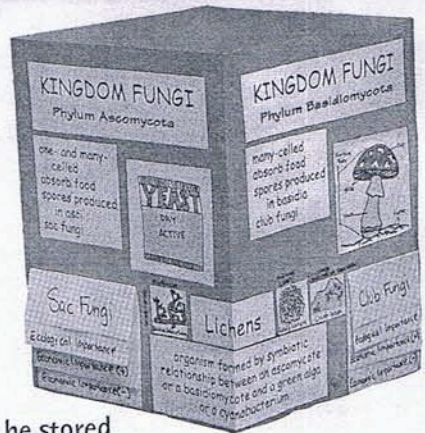
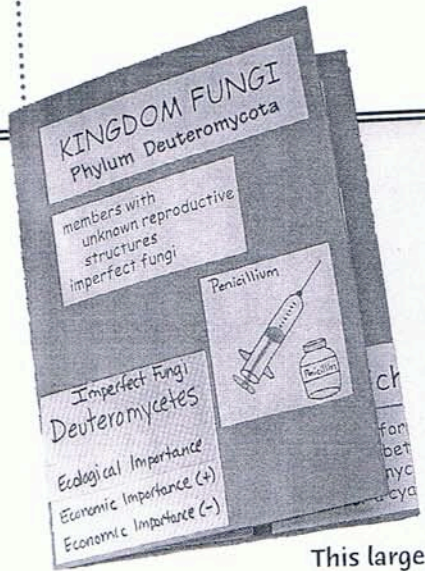

This large cube project can be stored in plastic bag portfolios. See page 4.